

- Standard Sixteenth Brick Footprint (DOSA)
- 36-75VDC Input
- 3.3V 25A - 12V 6.5A Nominal Outputs
- Through Hole Mounting
- Low 12.7mm Profile
- 1500VDC Basic Isolation

## iSA Series

75 - 82.5W

Sixteenth Brick Converter

### iSA Features and Benefits

#### Features

- High operating efficiency (up to 90%)
- Constant switching frequency
- 44% smaller than eighth brick

#### Benefits

- Reduced system heating
- Easier system filtering
- Optimization of board space

Specifications		iSA480		
ITEMS	MODEL			
Nominal Output Voltage	VDC	3.3	5	12
Input Voltage Range	VDC	36 to 75		
Input Current (max)	A	4		
Output Voltage Tolerance	VDC	3.20-3.40	4.85-5.15	11.58-12.42
Ripple & Noise (max) (pk to pk)	mV	100		200
Line Regulation (max)	mV	7	10	24
Load Regulation (max)	mV	8	10	24
Overload Protection	%	Inception- 130-147% of rated output; Short circuit auto recovery		
Overvoltage Protection	VDC	3.75-4.65	5.7-6.7	13.6-15.7
Remote Sense	-	Yes		
Remote On/Off	-	Negative Logic		
Temperature (operating)	°C	-40°C to +125°C		
Temperature (storage)	°C	-55°C to +125°C		
Humidity (operating)	-	20 - 95% RH Non condensing		
Humidity (storage)	-	10 - 95% RH Non condensing		
Cooling	-	Convection or forced air		
I/O Isolation Voltage	VDC	1500		
Vibration (non operating)	-	5 to 50Hz @ 0.5g (4.9m/s <sup>2</sup> ), and 50 to 500Hz @ 1.5g (14.7m/s <sup>2</sup> ) per Bellcore TR-EOP-000063-5.4.4		
Shock	-	196.1m/s <sup>2</sup>		
Safety Agency Approvals	-	IEC/UL/CSA/EN62368-1, 60950-1, CE Mark		
Weight (max)	g	30.4		
Size	mm	33 x 22.9 x 12.7		
Warranty	yrs	3		

**Model Selector**

Model	Voltage (V)	Adjust Range (V)	Max. Curr. (A)	Max. Output Power (W)	Efficiency at Full Load (%)
iSA48007A120V-001-R	12	10.8 - 13.2	6.5	78	90
iSA48015A050V-001-R	5	4.5 - 5.5	15	75	90
iSA48025A033V-001-R	3.3	2.97 - 3.63	25	82.5	88

**Preferred**

NB other configurations on request

**Recommended Hole Pattern**

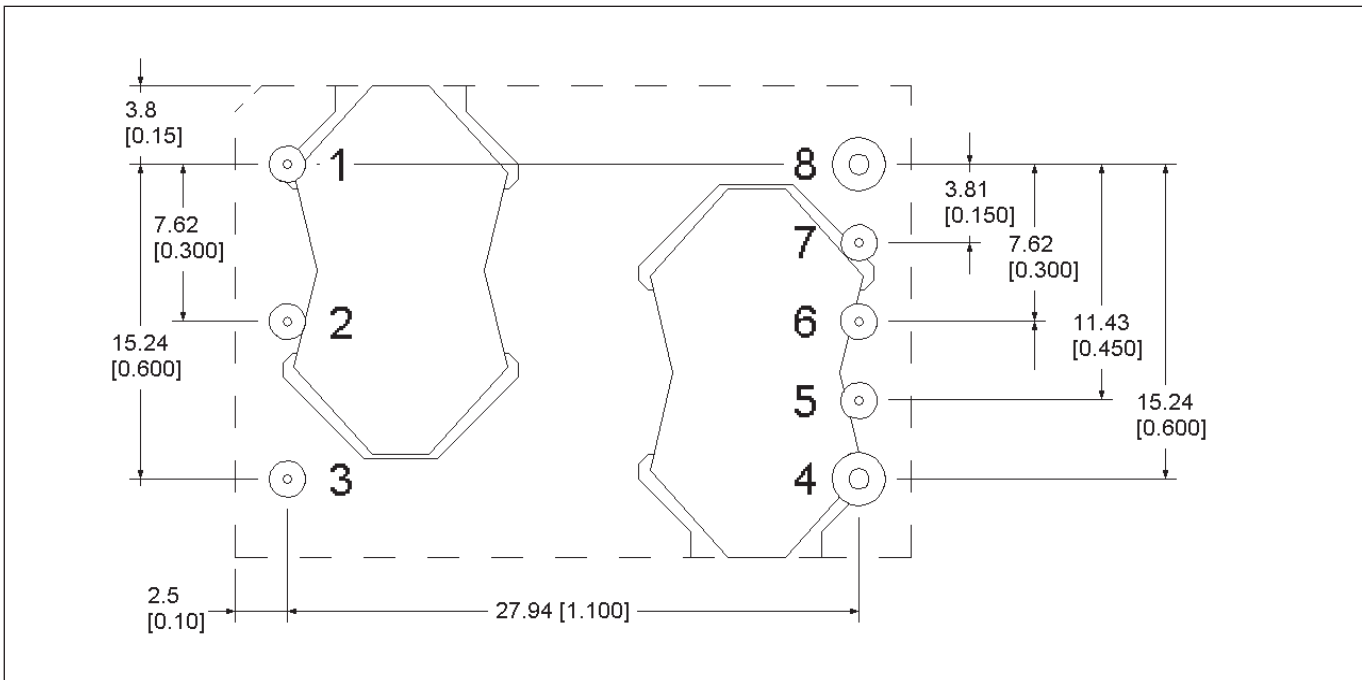

**Feature Set**

Feature Set	Positive Logic On / Off	Negative Logic On / Off	0.110" Pin Len.	0.180" Pin Len.	0.145" Pin Len.	Latching OVP
01		X			X	

**PIN Assignments**

Pin	Function
1	Vin (+)
2	On / Off
3	Vin (-)
4	Vout (-)
5	Sense (-)
6	Trim
7	Sense (+)
8	Vout (+)



**TDK-Lambda France SAS**

3 Avenue du Canada  
 Parc Technopolis  
 Bâtiment Sigma  
 91940 les Ulis  
 France  
 Tel: +33 1 60 12 71 65  
 Fax: +33 1 60 12 71 66  
[france@fr.tdk-lambda.com](mailto:france@fr.tdk-lambda.com)  
[www.emea.lambda.tdk.com/fr](http://www.emea.lambda.tdk.com/fr)



**Italy Sales Office**

Via Giacomo Matteotti 62  
 20092 Cinisello Balsamo (MI)  
 Italy  
 Tel: +39 02 61 29 38 63  
 Fax: +39 02 61 29 09 00  
[info.italia@it.tdk-lambda.com](mailto:info.italia@it.tdk-lambda.com)  
[www.emea.lambda.tdk.com/it](http://www.emea.lambda.tdk.com/it)



**Netherlands**

[info@nl.tdk-lambda.com](mailto:info@nl.tdk-lambda.com)  
[www.emea.lambda.tdk.com/nl](http://www.emea.lambda.tdk.com/nl)



**TDK-Lambda Germany GmbH**

Karl-Bold-Strasse 40  
 77855 Achern  
 Germany  
 Tel: +49 7841 666 0  
 Fax: +49 7841 5000  
[info.germany@de.tdk-lambda.com](mailto:info.germany@de.tdk-lambda.com)  
[www.emea.lambda.tdk.com/de](http://www.emea.lambda.tdk.com/de)



**Austria Sales Office**

Aredstrasse 22  
 2544 Leobersdorf  
 Austria  
 Tel: +43 2256 655 84  
 Fax: +43 2256 645 12  
[info@at.tdk-lambda.com](mailto:info@at.tdk-lambda.com)  
[www.emea.lambda.tdk.com/at](http://www.emea.lambda.tdk.com/at)



**Switzerland Sales Office**

Eichtalstrasse 55  
 8634 Hombrechtikon  
 Switzerland  
 Tel: +41 44 850 53 53  
 Fax: +41 44 850 53 50  
[info@ch.tdk-lambda.com](mailto:info@ch.tdk-lambda.com)  
[www.emea.lambda.tdk.com/ch](http://www.emea.lambda.tdk.com/ch)



**Nordic Sales Office**

Haderslevvej 36B  
 DK-6000 Kolding  
 Denmark  
 Tel: +45 8853 8086  
[info@dk.tdk-lambda.com](mailto:info@dk.tdk-lambda.com)  
[www.emea.lambda.tdk.com/dk](http://www.emea.lambda.tdk.com/dk)



**TDK-Lambda UK Ltd.**

Kingsley Avenue  
 Ilfracombe  
 Devon EX34 8ES  
 United Kingdom  
 Tel: +44 (0) 12 71 85 66 66  
 Fax: +44 (0) 12 71 86 48 94  
[info@uk.tdk-lambda.com](mailto:info@uk.tdk-lambda.com)  
[www.emea.lambda.tdk.com/uk](http://www.emea.lambda.tdk.com/uk)



**TDK-Lambda Ltd.**

1 Alexander Yanai  
 Segula  
 Petah-Tikva  
 Israel  
 Tel: +9 723 902 4333  
 Fax: +9 723 902 4777  
[info@tdk-lambda.co.il](mailto:info@tdk-lambda.co.il)  
[www.emea.lambda.tdk.com/il](http://www.emea.lambda.tdk.com/il)



**C.I.S.**

**Commercial Support:**  
 Tel: +7 (495) 665 2627  
**Technical Support:**  
 Tel: +7 (812) 658 0463  
[info@tdk-lambda.ru](mailto:info@tdk-lambda.ru)  
[www.emea.lambda.tdk.com/ru](http://www.emea.lambda.tdk.com/ru)

**Local Distribution**

