

**Input Parameters**

RATED INPUT VOLTAGE RANGE	100 - 240V AC
INPUT FREQUENCY	47- 63Hz
RATED INPUT CURRENT	1.5A
INRUSH CURRENT (132/264VAC)	25/50 (COLD START)

**Outputs**

**Output Parameters**

Models		
Model	Output Voltage (V)	Output Current (A)
ZP100-5	5	20
ZP100-9	9	11.2
ZP100-12	12	8.4
ZP100-15	15	6.7
ZP100-18	18	5.6
ZP100-24	24	4.2
ZP100-48	48	2.1

**Output Limitations**

The output voltage is factory set and should not be adjusted.

**Important safety instructions**

**Servicing**

These products are not customer serviceable. Repairs may only be carried out by TDK-Lambda Limited or their authorised agents. These products are not authorised for use as critical components in nuclear control systems, life support systems or equipment for use in hazardous environments without the express written approval of the Managing Director of TDK-Lambda Limited.

**Approval Limitations: Use in North America (AC units only)**

When this product is used on 180VAC-250VAC mains with no neutral, connect the two live wires to L(live) and N (neutral) terminals on the input connector. In this instance double pole fusing is required.

**High Voltage Warning**

Dangerous voltages present within the power supply. The professional installer must protect service personnel from inadvertent contact with these dangerous voltages in the end equipment.

**Safety Class of Protection**

These products are designed for the following parameters : Material Group IIIb, Pollution Degree 2, Overvoltage Category II, Class I, Indoor use as part of an overall equipment such that the product is accessible to service engineers only.

**Safety approvals**

UL60950-1 and CSA 60950-1 EN60950-1, Class I and CE (LVD) mark.

**Conducted and Radiated EMI**

EN55022-B, FCC Class B  
Immunity  
EN61000-4-2, EN61000-4-3, EN6100-4-4, EN61000-4-6, EN61000-4-8

**Environmental parameters**

**Operation**

Temperature: 0 to +70°C (ZPS100-5,-9,-48, >40°C -70°C derate at 2.5%/°C)  
0 to +70°C (ZPS100-12,-15,-18, -24, >40°C -70°C derate at 2.5%/°C)  
Humidity: 10 to 95% RH, non-condensing

**Storage and Transportation**

Temperature: -20°C to +85°C  
Humidity: 10% to 95% RH, non-condensing

**Shock**

<196.1 m/s<sup>2</sup> (20G)

**Vibration**

23.52 m/s<sup>2</sup> (10-55Hz): constant sweep 1 min X, Y, Z for one hour

**Cooling**

Convection

**Level of insulation**

Dielectric Strength testing is carried out as follows:  
Primary mains circuits to secondary -3kVAC.

**Fuse Information**

Internal fuse (F1): T2.2AL, 250V

**Input Connector**

Input connector mates with Molex housing 09-50-3031 and Molex 2878 series crimp terminal.

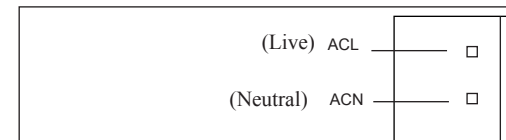

**General installation instructions**

The ZP family of component power supplies is designed for use within other equipment or enclosures which restrict access to authorised competent personnel only. For safe installation and operation of this product, carefully follow the instructions listed below.

- i) These products are supplied open frame
- ii) These products are Class I and must be installed in accordance with Class II requirements of IEC/EN/UL/CSAC60950-1
- iii) These products are IPX0, and therefore chemicals/solvents, cleaning agents and other liquids must not be used.

**Output Connector**

Output connector mates with Molex Housing 09-50-1081 and Molex 5194 series crimp terminal

ZPS100-5 Outline Drawing

All Dimensions are in inches[mm]  
Tolerances:..XX±.02[.XX±.5] unless otherwise noted

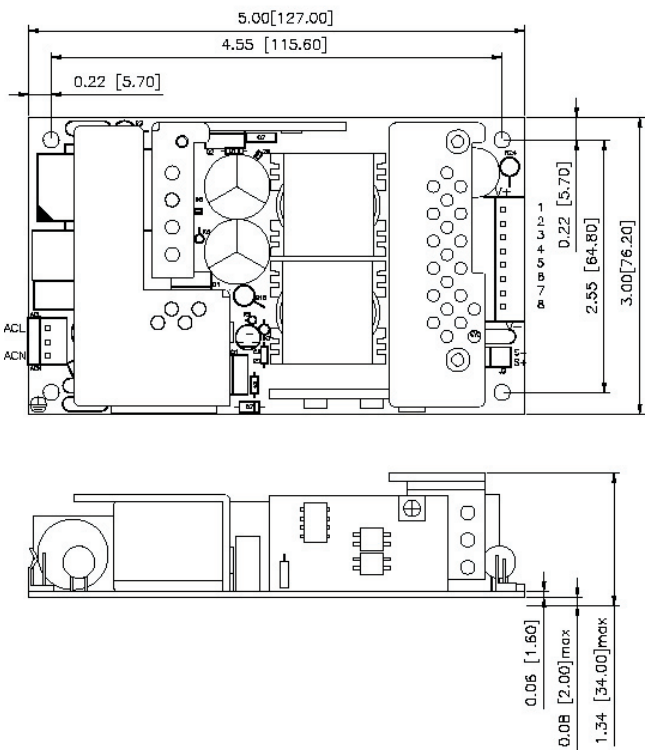

ZPS100-9,12,15,18,24,48 Outline Drawing

All Dimensions are in inches[mm]  
Tolerances:..XX±.02[.XX±.5] unless otherwise noted

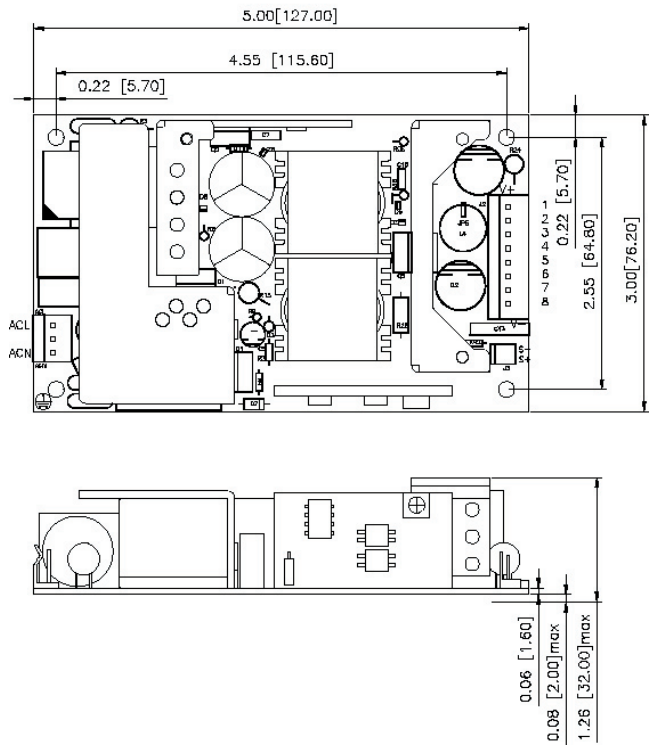

All dimensions are in inches (mm)  
Tolerances ..XX+/- .02(.XX+/- .5) unless otherwise stated

Part No 17163 Issue 04 February 2009  
TDK-Lambda UK Limited,  
Kingsley Avenue,  
Ilfracombe,  
Devon. EX34 8ES.  
Telephone - Sales and Service (01271) 856666  
Head Office and Works (01271) 856600  
Facsimile (01271)864894  
WEBSITE: www.uk.tdk-lambda.com